

Installing eMedReceiverCrypto

Here are the steps to securely transfer the results from the web to your local machine.

1) Download the necessary files by going to <http://www.medicalhistory.com/imhdownload/emedrcvcrypto.exe> and using the UserID "imhuser" and password "myIMH2008". This is a self-extracting file that should be unzipped to c:\temp (so you can erase them after installation)

2) After unzipping, please click on the set-up file that was created to install eMedReceiver to the c:\program files\emed directory (Figure 1). The practice can choose a different folder to accommodate network drives, etc. (Figure 2).

Figure 1



Figure 2

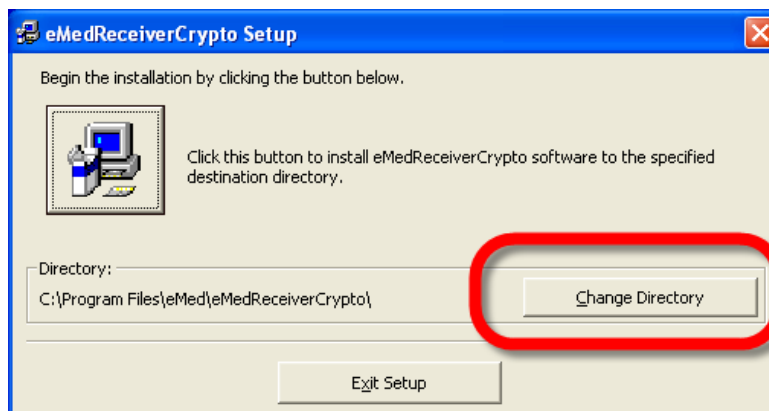

3) Please replace the existing ini file in the c:\program file\emed\emedReceiverCrypto directory with the attached *ini* supplied by Primetime Medical Software to connect the clinic's secure information (Figure 3). This file can be edited to adjust the output folder for your network configuration (Figure 4). The full path should follow a UNC path, such as \\server\imhoutput.

Figure 3



Figure 4

```
[type1]  
FullPath=c:\imh
```

4) In your start menu, please go to Programs, eMed, eMedReceiver to start the receiving and decrypting program. It will automatically check every 40 seconds. For now, the files you receive will go to c:\imh as a file for your EMR. The files may change if another EMR is used. The file folder may be changed, but **MUST** be matched in the EMR interface setup.

Please see "Autostarting eMedReceiver" for assistance in configuring your system to run eMedReceiver automatically each time the computer is started.